



PARAVAN Lancia Voyager

User manual

User manual/Lancia/Version 1.00



TABLE OF CONTENTS

1. Introduction	3
2. Operation of Sliding Door and Ramp	4
2.1. Operation by using rocker switches	5
2.2. Manual operation of the sliding door and ramp	6
2.3. Electric operation of the PARAVAN Lancia Sliding Door	7
2.3.1. Remote Control (Original LANCIA + PARAVAN)	8
3. Lowered Floor.....	10
4. Re-routed exhaust-pipe installation	10
5. Location of spare wheel	11
6. Front Seats with quick-release lock (if equipped)	12
6.1. Dismounting of the seats	12
6.2. Mounting of the seats:	13
7. Wheelchair anchorage system	13
7.1. Tie down of a wheelchair	14
8. Fuses.....	15
8.1. Fuses in passenger compartment – SPACE DRIVE (if equipped)	16
8.2. Fuses in motor compartment – SPACE DRIVE (if equipped)	17

Owner`s Manual PARAVAN Lancia Voyager

1. Introduction

Thank you for becoming the owner of a new PARAVAN Lancia Voyager.

This manual will familiarize you with operational, maintenance and safety information about your new vehicle. PARAVAN offers a great variety of options, components and features for its various models. Therefore, the equipment described in this manual, along with the various illustrations, may not all be applicable to your particular vehicle. This manual should remain in the car for your comfort. Because subsequent owners require this important information as well, this publication should remain with the vehicle if it is sold. All information contained in the Owner`s Manual is accurate at the time of publication.

PARAVAN reserves the right to make changes at any time so that our policy of continual product improvement can be carried out.

Security Advice

You will find various WARNING`s in this manual. These were prepared to enhance your personal safety. You should carefully read and follow ALL procedures and recommendations provided in these WARNING`s



- Indicates a situation in which harm, serious bodily injury or death could result if the warning is ignored.
- Indicates a situation in which damage to your vehicle could result if the caution is ignored.
- Indicates interesting or helpful information is being provided

2. Operation of Sliding Door and Ramp



ATTENTION: Make sure that no person or article rule in the range of the driven out ramp

To unlock the vehicle use the original LANCIA Remote Control.
Pressing “1” at the PARAVAN Remote Control will open the right sliding door, lower the car (if vehicle is equipped) and extend the ramp.

The suspension is only active if the switch at the dashboard is in Position “1”



PARAVAN Remote Control



Switch for suspension

If you don't want to activate the suspension (i.e. on a high sidewalk), bring the switch in Position “0” before pressing button “1”, so only the door will open, the ramp will be extended but the vehicle will not be lowered.

2.1. Operation by using rocker switches

You can also open the right sliding door, lower the car and extend the ramp by using rocker switches. They are located:

A) At the dashboard



B) on the B-Pillar right side



2.2. Manual operation of the sliding door and ramp

In case of an electric error, the sliding door and the ramp can also be operated manually. Although all door functions can be used without limitation (as in the original vehicle)



ATTENTION: The manual operation of the sliding door and ramp is an emergency function and can lead o increases wear!

Unlock doors by using the original LANCIA Remote Control or open sliding door manually.

The door must be opened as far as its end stop and remain in that position.

There is a little whole in the carpet. Use the supplied Allen Key to turn a screw clockwise to unlock the ramp.

Pull out the ramp horizontally of the intermediate compartment in the floor until it reaches the rear end by using the handle of the ramp that you will find below the ramp cover.



Allen Key to unlock the ramp

Continues on page 6

The ramp can only be lowered to the ground after it has been fully pulled out. To stow the ramp to its storage position, take hold of it by its handle, lift it and push it back horizontally into its floor compartment. Make sure to lock the ramp with the Allen Key



ATTENTION: The Sliding Door can only be closed after the ramp has been stowed properly in the floor compartment. Make sure to lock the ramp !

2.3. Electric operation of the PARAVAN Lancia Sliding Door

You can also open the sliding door by using the original LANCIA Remote Control.

In this case the ramp will not be extended.

To lower the car and extend the ramp press button "1" on the PARAVAN Remote Control



The ramp does not have an automatic stop and reversal function !
Never intentionally place any object or part of your body in the path of the ramp.
This could result in serious injury or cause damage to the vehicle.

2.3.1. Remote Control (Original LANCIA + PARAVAN)

To open the sliding door electrically press one of the buttons (left or right) of the LANCIA Remote Control for more than 1 sec.

LANCIA REMOTE CONTROL



Sliding Door Driver Side

Sliding Door Passenger Side

PARAVAN REMOTE CONTROL

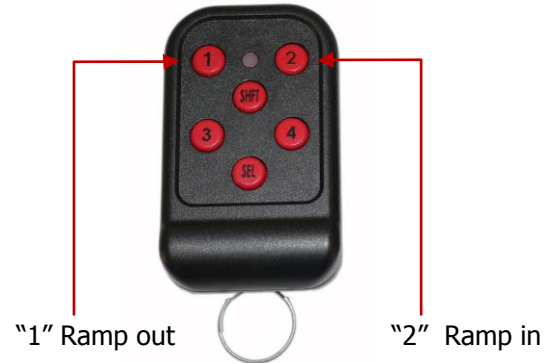

"1" Ramp out

"2" Ramp in

To lower the car and extend the ramp press button „**1**“ on the PARAVAN Remote Control
To stop the ramp at any position press "**1**" again.

To continue extending the ramp press "**1**" within 10 sec.

To change direction and stow the ramp press "**1**" during extension, wait for 10 sec. and press "**2**"

2.3.2. Main control buttons on the overhead console

You can also operate the sliding doors by pushing the corresponding main control button on the overhead console

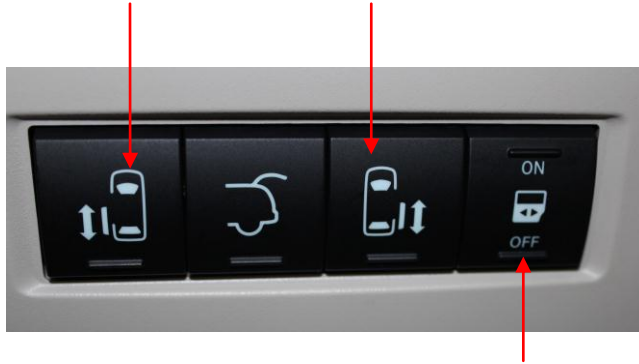

Make sure the Power ON/OFF button is in correct position, doors can not be operated in OFF modus



The ramp does not have an automatic stop and reversal function !
Never intentionally place any object or part of your body in the path of the ramp.
This could result in serious injury or cause damage to the vehicle.

3. Lowered Floor

The entire conversion of the vehicle is based on a lowered floor. It extends from the rear seat bench to the foot pedals



ATTENTION: The ground clearance of the vehicle is reduced, which requires you take into consideration the circumstances and drive carefully. The lowest point of the floor is a solid steel-frame construction. Should the vehicle bottom be damaged in any way, the bottom protection must be repaired immediately

4. Re-routed exhaust-pipe installation

Because of the vehicle's lowered chassis, the exhaust system has been re-routed through a sideways running duct in the floor assembly – which is one of the reasons why you should drive with care. Make especially sure that there is enough clearance underneath the vehicle.

5. Location of spare wheel

Because the vehicles bottom is lowered and the fuel tank is replaced to the rear of the vehicle, the spare wheel is located inside the vehicle behind the rear bench seat. It is recommended to buy an emergency package, which includes a tire-filler foam.



ATTENTION: When jacking up the vehicle, remember that due to the sillboards it is difficult to jack up the vehicle using the original jack-up points.

6. Front Seats with quick-release lock (if equipped)

6.1. Dismounting of the seats



ATTENTION: Before dismantling the seats make sure that the electrical connection is disconnected.

IMPORTANT: disconnect only when Ignition is turned off.



The locks of the seat base are operated by means of a handle on the RH side of the seat consoles. To release the seat, pull the handle backwards as far as its end stop. Then pull the entire seat back slightly and tilt it towards the rear. This will allow you to roll the seats out of the vehicle without exerting much effort.

6.2. Mounting of the seats:

Fasten the seats in the reverse order. Make absolutely sure that the release grip is pushed all the way to the front when the seats are refastened. This is the only way to secure them!



ATTENTION: Make sure to connect the electric function when ignition is turned off and check that the grip is locked properly.

7. Wheelchair anchorage system



ATTENTION: Make sure that the wheelchair is fixed properly and a headrest is installed !

A PARAVAN Lancia optionally includes a belt system for securing wheelchairs in the vehicle. This system is made up of aluminium rails permanently mounted to the vehicle and a set of belts. The aluminium rails in the vehicle are located in front of the rear seat bench, in front of the front seats and between the seats. This arrangement makes it possible to secure wheelchairs. The set of belts that is part of the anchoring system comprises:

- 1) two belts with permanent adjustment to fix the wheelchair in the front
- 2) two belts with quick-release locks + tensioning knob to fix the wheelchair from the back
- 3) one seat belt stalk (optional) to use the original 3-point-belt

7.1. Tie down of a wheelchair

- The end of each of the two belts with permanent adjustment is clicked into the front belt rail using the quick-release connection and the other end is fastened to the frame of the wheelchair.
- 2 belts with tensioning knob to be connected to the rear side aluminium rail, using the quick-release connection.
The other end of the belt has to be connected to the frame of the wheelchair.
The tensioning belt is pretensioned by opening the tensioning lock and pulling the belt.
Close the tensioning lock to secure the wheelchair. If the wheelchair is not fixed properly, open the tensioning lock and retighten the belt.

8. Fuses

The fuses for the suspension and ramp function are located in the trunk on the left side

To check and change a fuse:

- Remove the plastic cover
- Remove the cover of the yellow fuse box



Cover

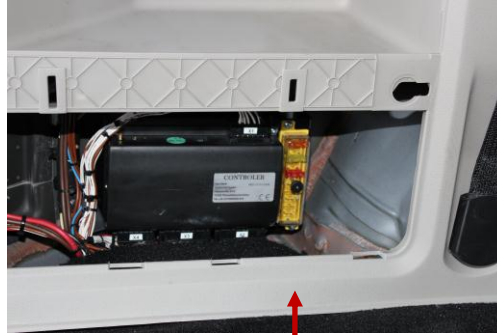

Yellow fuse box



ATTENTION: when changing a fuse, make sure to use the correct amperage. Using a wrong amperage can cause overload of the electric system.
If a fuse is burning again after it is being changed please contact your service to find the cause of the malfunction.

8.1. Fuses in passenger compartment – SPACE DRIVE (if equipped)

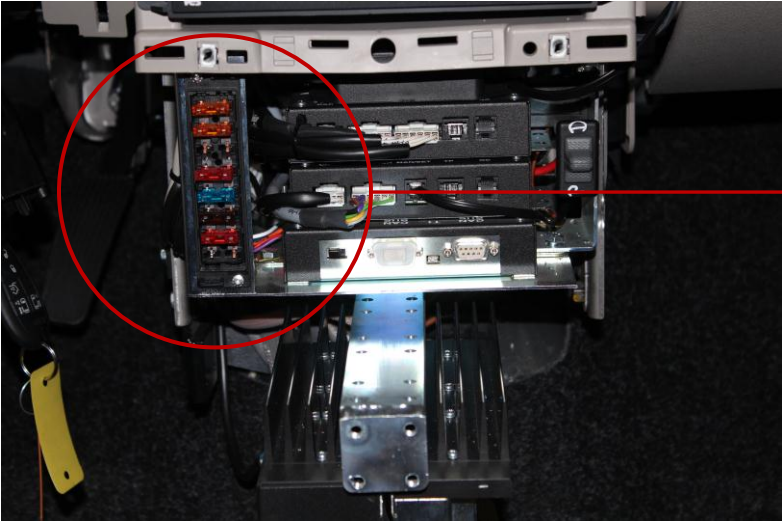

Located in the middle console

8.2. Fuses in motor compartment – SPACE DRIVE (if equipped)





PARAVAN[®].de
BEHINDERTENGERECHTE FAHRZEUGUMBAUTEN



PARAVAN GmbH

PARAVAN Str. 5-10
D-72539 Pfronstetten-Aichelau
Deutschland

Tel: +49 (0)7388 - 99 95 60
Fax: +49 (0)7388 - 99 95 999
Web: www.PARAVAN.de
Mail: info@PARAVAN.de

